

**GRACE**

**Grace 系列安装说明书**

Grace series installation instructions

系 列	灯头数	开孔尺寸 (mm)	系 列	灯头数	开孔尺寸 (mm)
1371210	单头	135×135	1571210	单头	160×160
2371210	双头	280×135	2571210	双头	330×160
1971210	单头	105×105	DR00907	单头	100×100
2971210	双头	215×105	DR00908	双头	195×100
3971210	三头	325×105	DR00909	三头	285×100
DR00901	单头	70×70	DR00904	单头	66×66
DR00902	双头	130×70	DR00905	双头	127×66
DR00903	三头	190×70	DR00906	三头	187×66

**一、安装步骤:**

**1** 按型号对应的开孔尺寸在天花板安装位置开孔, 适合天花板厚度8-20mm.

**2** 断电情况下, 将驱动端电源线接市电 (不含驱动需先接适配恒流驱动).

220-240V~

**3** 配公母插的, 需将驱动与灯具公母插对接扭紧.

**4** 整理好电源线, 将驱动置入天花孔内.

**5** 按压弹片, 把灯体装入天花孔.

**6** 安装完成.

具体外观以实物为准!

**安装步骤二(无边框带预埋件安装):**

预埋件需在批灰前安装好.

**1** 在天花板安装位置根据型号对应的开孔尺寸开孔.

**2** 用4个自攻墙板钉均布的将预埋件固定在天花板开孔上.

**3** 批灰: 以刚好盖住预埋件下边缘为准, 约3mm厚度, 批完灰后, 清理干净内表面.

**4** 断电情况下, 引出电源线将驱动端电源线接市电 (不含驱动需先接适配恒流驱动).

220-240V~

5 整理好电源线，将驱动从开孔处置入天花板上，然后将灯具卡入天花孔内。

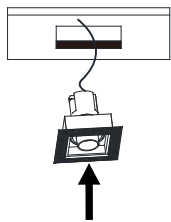

以上步骤仅限安装无边框预埋件的灯具，具体外观以实物为准！

### 三、更换前环与光学引擎：

以下步骤仅对有更换功能的灯具

1 断电后，将灯具摆动倾斜，用手抓着灯具缺口位置向下拉。

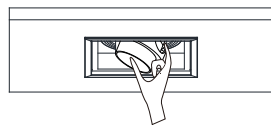

2 拉出灯具。

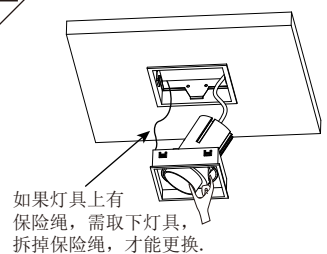

如果灯具上有保险绳，需取下灯具，拆掉保险绳，才能更换。

5.

3 拆分电源线。

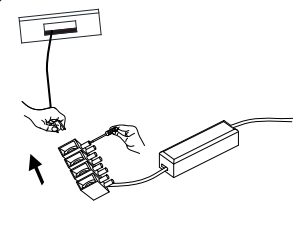

4 接好电源线，检查回路确认无误后，锁好保险绳，灯体推入面框，安装灯具。

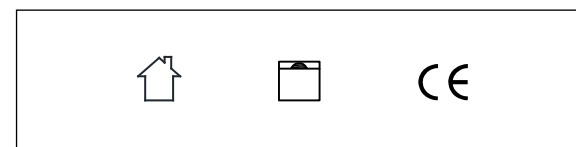
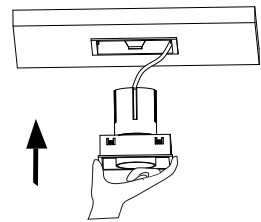

该产品只能安装在室内环境，不能与水接触。  
This product is only suitable for indoor. It is not allowed to be rinsed with water.

外置LED驱动，嵌入式安装。  
Independent external driver, Recessed mounted.

6.

不要用手或者毛巾拭擦芯片与反射器！  
Do not clean LED chip and reflector with hand or towel !



- 只能使用符合IEC或CCC安全标准的电源；
- 检查电源是否匹配灯具；
- 须考虑到最大电流值；
- 灯具上显示电压不是用来选择恒压电源，而是表示所选恒流电源所覆盖的电压；
- 采用合适的ESD措施，避免触摸裸导体；
- 若与某种化学物质或气体接触，LED芯片会受损；
- 因此不能用化学物质清理LED壳体或LED驱动灯，如下物质证实对灯具的性能有负面影响，不能与LED灯具处在同一环境下。

指甲油  
超能胶水  
乙二醇  
甲醛  
LOCTITE胶水  
漂白粉，含漂白粉的清洁剂、喷雾剂  
LOCTITE 384胶  
LOCTITE 7387 活化剂

- 将绝缘物移开或提供足够空间以便灯具本身的温升不会超过额定的；
- LED芯片对开关瞬态很敏感，因此LED灯具与电器必须在断电状态下连接，不可热插拔。
- VF建议使用灯具说明书上指示的电源。
- 须顾及到产品的极性。
- 如果此灯具的外部软缆或软线损坏了，该线要由制造商或其服务代理商或有类似资格的人更换
- 此灯具内的光源应由制造商或其服务代理商或有类似资格的人来更换

7.

- Use only drivers that comply with IEC or CCC safety standards.
- Check if the power supply match with the luminaire.
- Must consider the maximum current value displayed on the label of the luminaire.
- The voltage displayed on the luminaire is not used to select the constant voltage driver, but the voltage covered by the selected constant current driver.
- Take suitable ESD measures to avoid touching bare conductors.
- LED chips can be damaged if be in touch with chemical material or gas. Therefore, it is not allowed to clean the LED housing or luminaire by chemicals.
- The following items are confirmed to have negative impact on the performance of the luminaire, avoid to keep luminaire in the same circumstance with them.  
Methyl acetate or ethyl acetate (i.e., nail polish remover)  
Cyanoacrylates (i.e., "Superglue")  
Glycol ethers (including Radio Shack ® Precision Electronics  
Cleaner - dipropylene glycol monomethyl ether)  
Formaldehyde or butadiene (including Ashland PLIOBOND ® adhesive)  
Dymax 984-LVUF conformal coating  
Loctite Sumo Glue. Loctite 384 adhesive. Loctite 7387 activator  
Gorilla Glue. Bleach, Bleach-containing cleaners, sprays

- Remove the insulation material from the luminaire or provide enough space so that the temperature raising will not overpass the limited TC.
- LED chip is very sensitive to switching transients, therefore, LED lamps and appliances must be connected after power cut off, no hotswappable.
- VF recommends using the driver indicated on the luminaire manual.
- Must consider the polarity of the product.
- If the external flexible cable or cord of this lamp is damaged, the cord should be replaced by the manufacturer or its service agent or a similarly qualified person
- The light source in this lamp should be replaced by the manufacturer or its service agent or a similarly qualified person

爱加照明科技有限公司

广东省东莞市大朗镇洋乌村乌石岭三区438号  
Tel: 0769-8539 7723 / 8539 7729 Fax: 0769-8258 3418  
E-mail: info@vflighting.com Http: //www.vflighting.com

8.